

	Lavabo / Washbasin
	NIVIS
	ACER0763FM0
	Lavabo indipendente in Marmo Marble independent washbasin

MANUTENZIONE

Per la normale pulizia si consiglia di utilizzare detersivi di uso comune. Si sconsiglia l'utilizzo di detersivi abrasivi, acidi e anticalcare.

MANUTENZIONE

Leggere attentamente le istruzioni di manutenzione del Marmo

MAINTENANCE

For normal cleaning use common detergents. Do not use either abrasive detergents or solvents, acids and anti limestone.

MAINTENANCE

Carefully read the Marble maintenance instructions

Agape srl

via A. Pitentino, 6 46037 Governolo
 Roncoferraro (MN), Italy

T +39 0376 250311 / F +39 0376 250330

e-mail: info@agapedesign.it

www.agapedesign.it

ACER763FM0 - NIVIS		2/4
COD. 202217	VERS. 2022045/1- SV	

CONTENUTO DELLA CONFEZIONE
PACKAGE CONTENTS

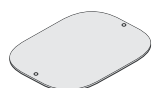
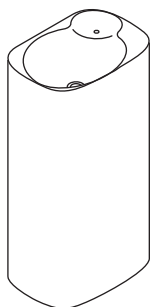

Dima/Template

STRUMENTI
TOOLS

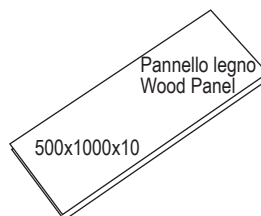

trasparente - antimuffa
transparent - antimould



nastro adesivo di carta.
masking tape.

PREDISPOSIZIONE
WASHBASIN PREDISPOSITION

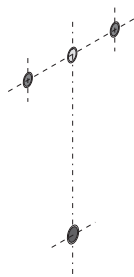

LAVABO INSTALLATO
WASHBASIN MOUNTED

RUBINETTO A PARETE
WALL MOUNTED TAP

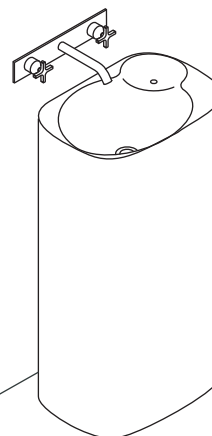

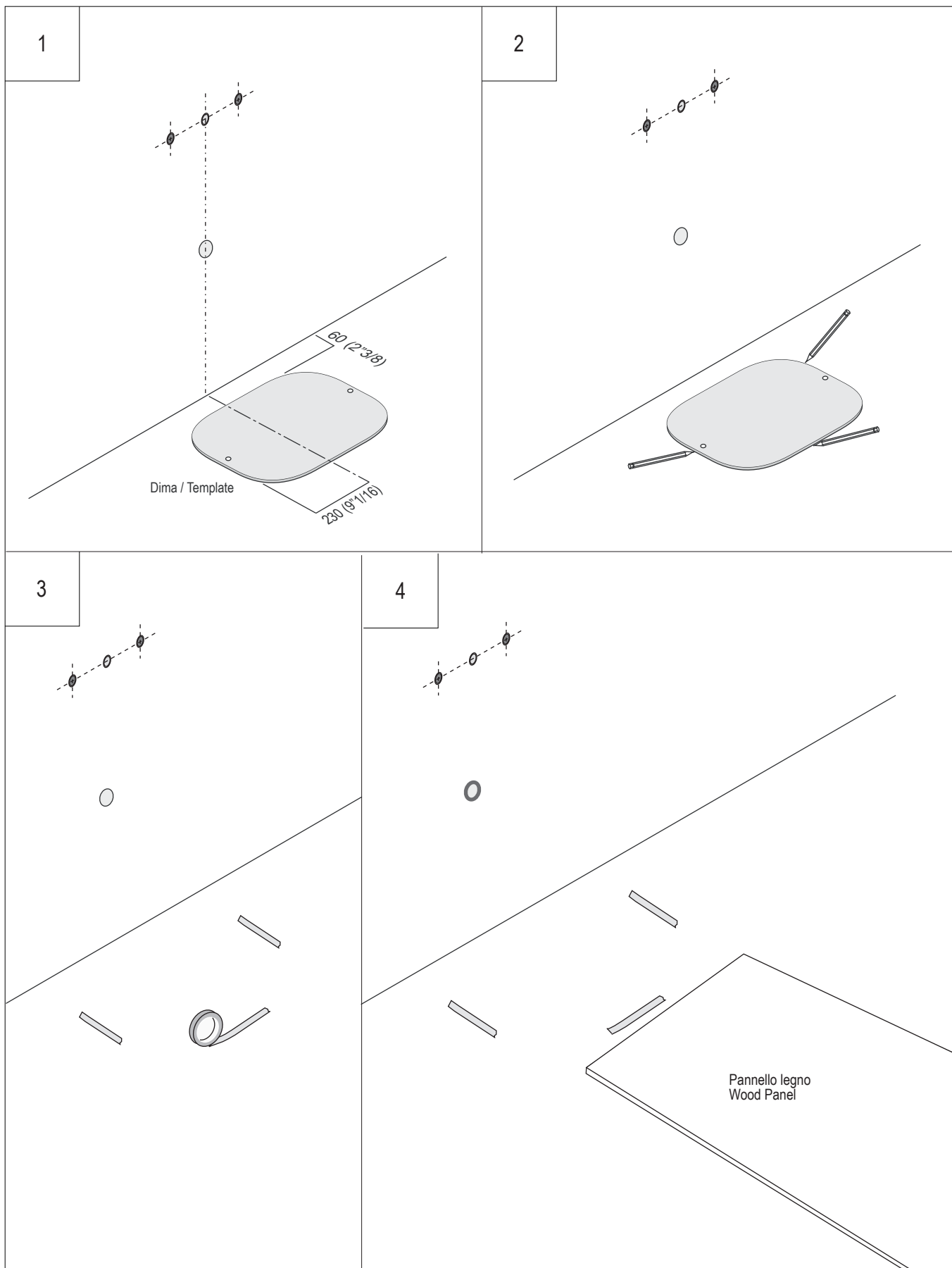

<p>5</p> <p>.MET0563</p> <p>Collegare il troppo pieno alla piletta Connect the overflow to the drain</p>	<p>6</p> <p>SE SERVE TAGLIARE LA PARTE IN ECCESSO IF NECESSARY CUT THE PIPE TO LENGTH</p> <p>Interruzione Interruption</p> <p>Pannello legno Wood Panel</p>
<p>7</p> <p>Applicare un adeguato strato di silicone tra il lavabo e il pavimento. Apply a suitable quantity of silicone between washbasin and floor.</p> <p>silicone</p> <p>Filo davanti Front line</p> <p>Pannello legno Wood Panel</p>	<p>8</p> <p>STOP 24 h.</p>